

- LEYENDA ARMARIOS
- Ⓒ PUERTAS CORREDERAS
  - Ⓐ PUERTAS ABATIBLES
  - Ⓢ.P. SIN PUERTAS

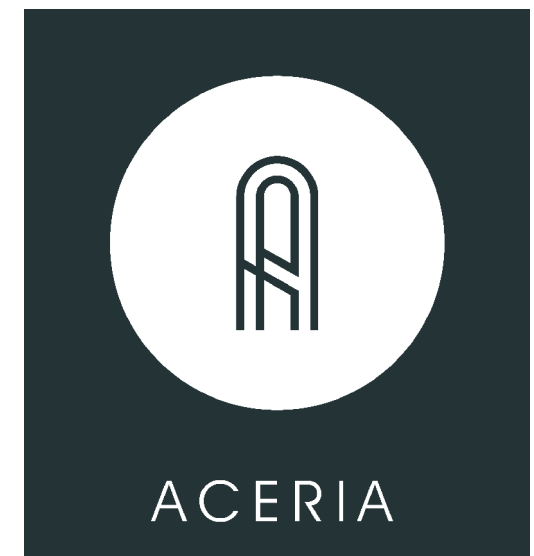

FASE II

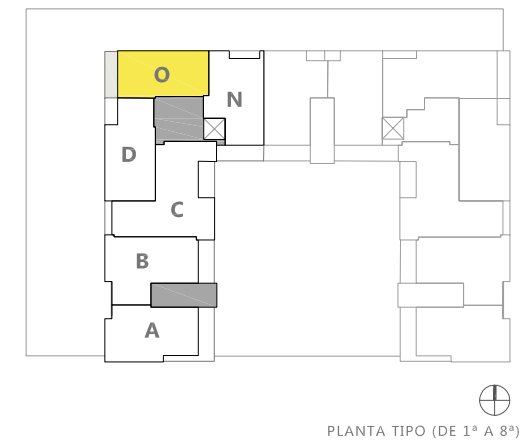

e 1/75 0 | 1 | 2 | 3 | 4

VIVIENDA O

SUPERFICIES ÚTILES (m<sup>2</sup>)

|  |              |
|--|--------------|
| RECIBIDOR  | 4.69         |
| SALÓN-COMEDOR  | 20.85        |
| COCINA   | 9.36         |
| PASILLO  | 2.92         |
| BAÑO 1   | 3.58         |
| BAÑO 2   | 3.60         |
| DORMITORIO 1 + VESTIDOR                                  | 14.48        |
| DORMITORIO 2   | 10.69        |
| <b>SUP. ÚTIL CERRADA VIVIENDA O</b>                      | <b>70.17</b> |
| TERRAZA  | 10.49        |
| <b>SUP. ÚTIL ABIERTA VIVIENDA O</b>                      | <b>10.49</b> |
| <b>TOTAL SUP. ÚTIL VIVIENDA O</b><br>(ABIERTA + CERRADA) | <b>80.66</b> |